

## Description



The JGX-502 Spray Gun is a conventional air spray gun, patterned after the JGA series, whose functions are similar to standard air spray gun models. The gun is available in three types: gravity feed, suction feed, and pressure feed, in order to cover the widest range of applications.

With all areas of the fluid passages made from stainless steel, the JGX-502 can be used with a wide range of paints, with the only exception being those of a highly corrosive and/or abrasive nature. The use of such materials will require thorough cleaning and frequent part replacement.

Any questions regarding the operation of the JGX Spray Gun should be directed to us or our distributors BEFORE use.

## Types and Specifications

The JGX are specified when ordering as follows;

JGX - 502 —  —  — ( )  
Air cap No. Tip Size Feed Type.

<Example> JGX-502-143-FF-G

This represents a gun with a number 143 Air cap, a Size FF Fluid Tip, and set up for Gravity Feed.

## Operations

Before using the gun, the needle packing, which is shipped loose to avoid binding, should be adjusted.

The packing gland (Part #7) should be gradually screwed clockwise while triggering the gun up to the point where the needle does not smoothly return to the closed-position. At this point the packing gland should be slightly loosened by screwing it in counterclockwise so that the needle moves freely.

Adjust the atomizing air pressure to the lowest level possible and commensurate with proper atomization quality desired, to minimize overspray and maximize paint transfer efficiency.

The spray gun should be used at all times perpendicular to the surface to be coated at a distance of 150-200mm.

## Maintenance

The gun should be cleaned and lubricated daily to maintain its optimum performance. Clean the paint passages thoroughly by spraying solvents through the gun after use.

The gun body should never be soaked in the solvent for cleaning. Exterior surface should only be wiped with solvent dampened rags.

The air caps should be detached from the gun and soaked in the solvent.

Use toothpicks to remove any paint build up from the air cap holes. NEVER use metal objects to clean the air caps in order to avoid damage to the fine holes, which will cause the spray pattern to become distorted.

A drop of lubricant should be applied regularly to the trigger bearing stud (#25), the stem of the air valve assembly (#21), and the needle packing gland (#7). For optimum results use SSL-10 Spray Gun Oil.

The Needle Spring (#11) and the Air Valve Spring (#22) should be lightly greased. Do not lubricate or grease excessively in order to avoid clogging in the air passages.

## Replacement of Parts

A wrench (JGX-34) is provided with the gun.

When replacing the fluid tips, ensure that the Fluid Needle Adjustment Screw is removed, and also ensure that the Spreader Valve is in the fully open (counterclockwise) position.

Whenever the Fluid Inlet Nipple (#23) or the Air Inlet Nipple (#28) are replaced, a sealant material such as Loctite 242, should be applied to the thread before inserting it into the gun body. The same sealant should also be used on the body thread of the Spreader Valve (#13) and the Cheater Valve (#27).

## Specifications

Air and Fluid Inlet Threads:

Fluid: Suction/Pressure Feed  
PF3/8 Male, standard  
PF1/4 Male, Optional

Air Inlet: PF1/4

Weight: Suction/Pressure Feed 440g

## Accessory Items

- TLC-555 1 Litre Suction Cup (with Teflon\* Coated Inner Lining)
- KG-503-1 400cc Side Cup (Gravity Feed)
- KG-503-1-T 400cc Side Cup (with Teflon\* Coated Inner Lining, Gravity Feed)
- KG-400 400cc Side Cup With Stand (Gravity Feed)
- KG-400-T 400cc Side Cup With Stand (With Teflon\* Coated Inner Lining, Gravity Feed)
- KB-II KB-555 2 Litre Pressure Feed Remote Cup
- KR-470-1 700cc Suction Cup Assembly
- HD-505 5 Litre Gun & Hose Cleaner
- JGX-101 Repair Kit
- SSL-10 Spray Gun Lubricant. Silicone-free, Non-petroleum product
- HAF-507 Disposable Air Line Filter

\* Teflon, and Delrin are both the registered marks of E.I. Du Pont de Nemours and Company.

Chart 1 : Aircap-Fluid Tip Combination

Aircap				Fluid Tip Size			
No. on CAP	Code	Part Number	Gun Type	GY	FX	FF	EX
103	803737	JGX-3-103	S, G	V			
143	803739	JGX-3-143	S, G		V	V	V
165	803740	JGX-3-165	P		V	V	

Chart 2 : Selection of the Fluid Tip and the Needle

Fluid Tips				Fluid Needles		Gun Type
No. on TIP	Size(mm)	Code	Part Number	Code	Part Number	
GY	0.8	803775	JGX-4-GY	803750	JGX-41-GX	S, G
FX	1.1	803786	JGX-401-FX	803751	JGX-41-FX	G, P
FX	1.1	803747	JGX-4-FX	803751	JGX-41-FX	S
FF	1.4	803787	JGX-401-FF	803752	JGX-41-FF	G, P
FF	1.4	803748	JGX-4-FF	803752	JGX-41-F F	S
EX	1.8	803749	JGX-4-EX	803753	JGX-41-EX	G, S

Notice: The fluid tip of Suction Feed gun and GY Tip (0.8m/m) is not with soft-seat.

Chart 3 : Fluid Inlet Description

Paint Supply	Thread	Code	Part Number	Remarks
S, P	PF3/8	803767	JGX-1	—
S, P	PF1/4	803768	JGX-35	optional
G	PF1/4	803769	JGX-2	—

Chart 4 : JGX-502 Parts List

#	Code	Part Number	Description	pcs	#	Code	Part Number	Description	pcs
1	803736	JGX-5	Retaining Ring	1	13	803760	JGX-44	Spreader Valve Assy.	1
	803735	JGX-6	Retaining Ring, brass(Optional)	1	17	803764	JGX-43	Air Valve Assy.	1
2		See Chart 1	Air Cap	1	19*			Packing	1
3		See Chart 2	Fluid Tip	1	20*			O-Ring	1
4	803741	JGX-7	Baffle	1	22	803778	JGX-25	Spring	1
5*	803783	JGX-8-K5	Gasket(a set of 5 pcs.)	1	23		See Chart 3	Fluid Inlet Nipple	1
6*	803855	JGV-463	Needle Packing(2 piece)	1	24	803916	JGS-108-1	Trigger	1
7	803784	JGX-11-K3	Packing Gland(a set of 3 pcs.)	1	25	803567	JGX-45-K5	Bearing Stud(a set of 5 pcs.)	1
8*			Gasket	1	26*	805281	JGX-46-K10	Circlip(a set of 10 pcs.)	1
9	803745	JGX-12	Bushing	1	27	803771	JGX-42	Cheater Valve Assy.	1
10		See Chart 2	Fluid Needle	1	28	803772	JGX-30	Air Inlet Nipple	1
11	803785	JGX-14-K3	Needle Spring(a set of 3 pcs.)	1	29	803773	JGX-34	Wrench	1
12	803759	JGX-13	Adjusting Screw	1		803733	JGX-101	Repair Kit	1

JGX-101 Repair Kit includes maintenance parts marked.\*

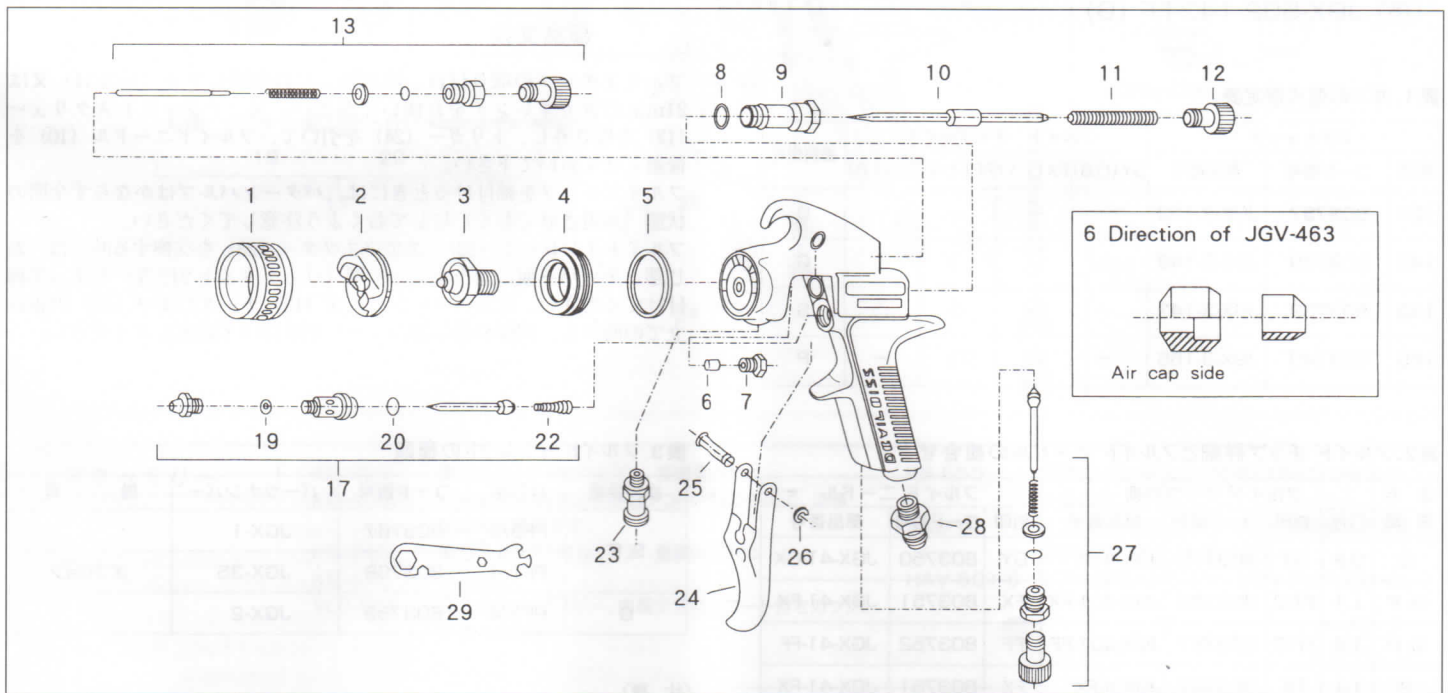

For further information, please contact:

Distributed by:

**DeVilbiss Division**  
**Ransburg Industrial Finishing KK**  
 1-15-5 Fukuura, Kanazawa-ku, Yokohama-city,  
 Kanagawa PREF. 236-0004 Japan  
 TEL 81-45-785-6434 FAX 81-45-785-6517