

SERIES 800A SWITCHES

SEALED SUB-MINIATURE PUSHBUTTON SWITCHES



SPECIFICATIONS

Ratings: 1A @ 120 VAC
 Electrical Life: 50,000 cycles typical
 Contact Resistance: 10mΩ max. typical @ 2-4 VDC
 100mA for both silver and gold plated contacts.
 Insulation Resistance: 1,000MΩ min.
 Dielectric Strength: 1,000 V rms @ sea level.
 Operating Force: 200 ± 50 gf

MATERIALS

Case: Diallyl Phthalate (DAP)
 Plunger: Glass filled nylon or glass filled polyster
 Bushing: Nickel plated brass
 Housing: Stainless steel
 Contacts: Silver or Gold plated copper alloy.

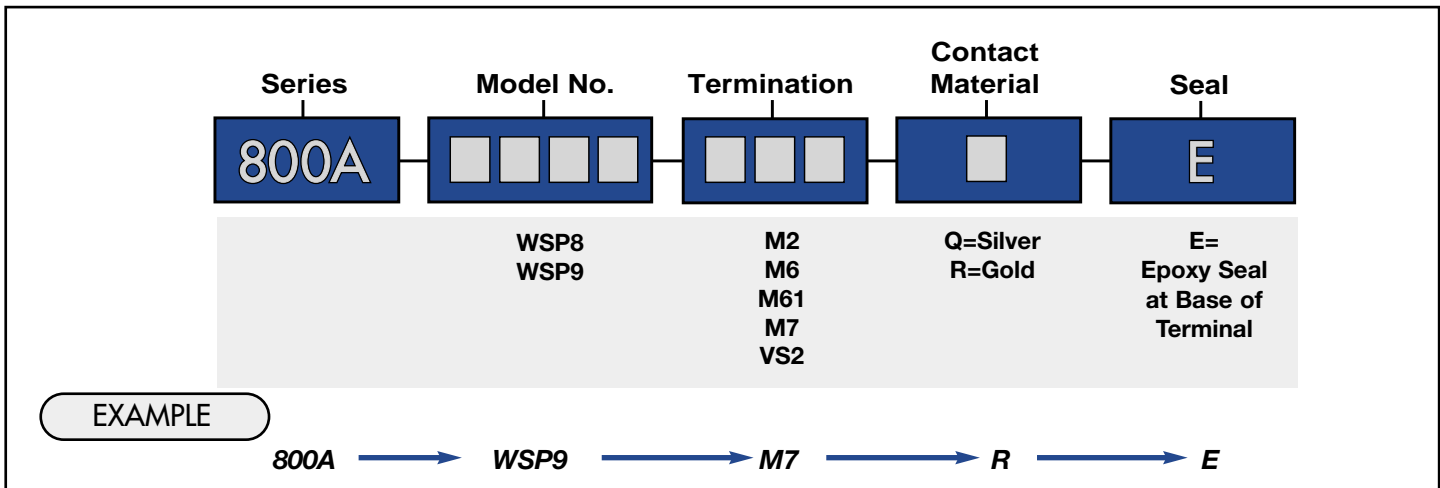

SPECIFICATIONS SUBJECT TO CHANGE WITHOUT NOTICE.



Model No.	TYPE	
WSP8	ON	(ON)
WSP9	OFF	(ON)

Schematic () = Momentary

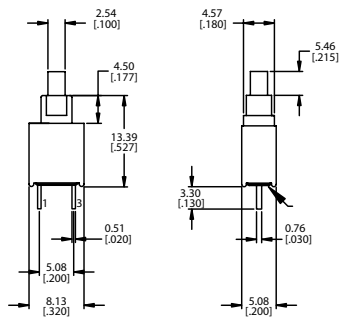
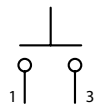

P.C. MOUNTING

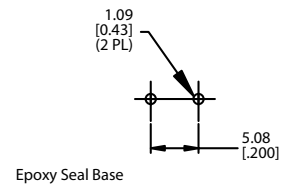

TERMINATION OPTIONS

M2 P.C. Mounting

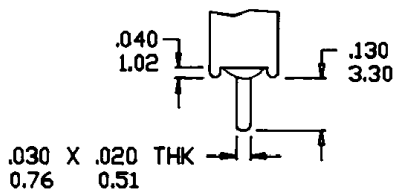

SERIES 800A SWITCHES

SEALED SUB-MINIATURE PUSHBUTTON SWITCHES

TERMINATION CONTINUED



M6

SPST

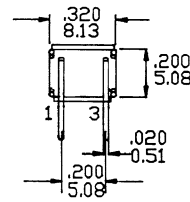
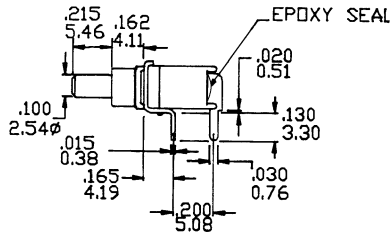
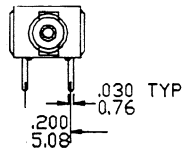

P.C. MOUNTING

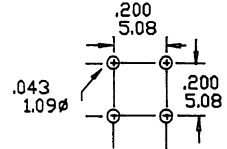

M61

SPST

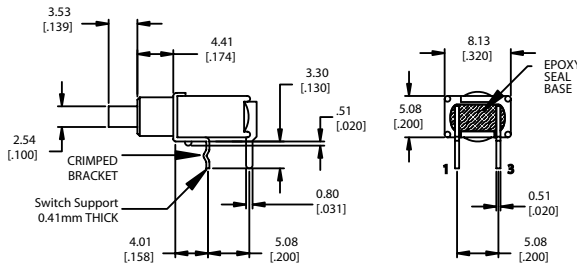
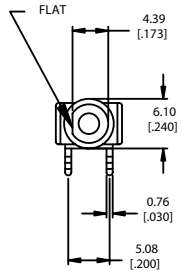

P.C. MOUNTING

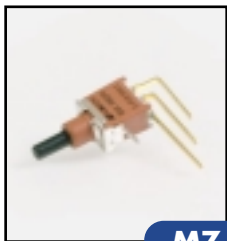
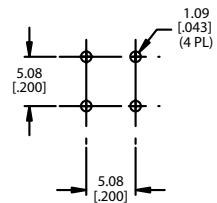

M7

SPST

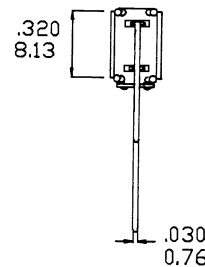
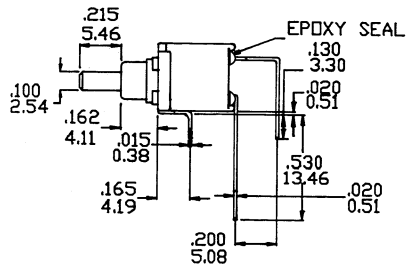
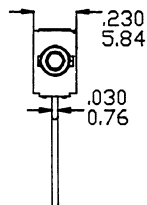

P.C. MOUNTING

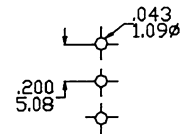

VS-2

SPST

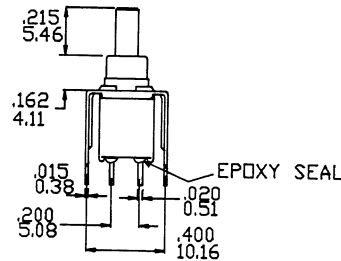
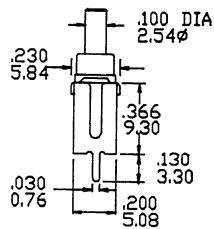

P.C. MOUNTING

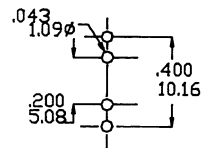

CONTACT MATERIAL OPTIONS

Q

Fixed Terminal: Silver plated copper alloy.
Moving Contacts: Silver plated copper alloy.
Rating: 1 AMP @ 120VAC or 28 VDC.

R

Fixed Terminal: Copper alloy with gold plate over nickel plate.
Moving Contact: Copper alloy with gold plate over nickel plate.
Rating: 0.4 VA max. @ 20 VAC or DC max.

SPECIFICATIONS SUBJECT TO CHANGE WITHOUT NOTICE.