

SHARP®

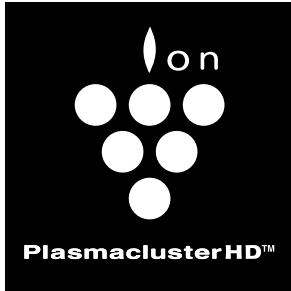

Plasmacluster and Plasmacluster HD are trademarks of SHARP Corporation.

Plasmacluster 和 Plasmacluster HD 為 SHARP 株式會社的註冊商標。

Plasmacluster Ion Generator OPERATION MANUAL

ENGLISH

中文

IG-A20A IG-A40A

HD 離子簇抗菌機 使用說明書

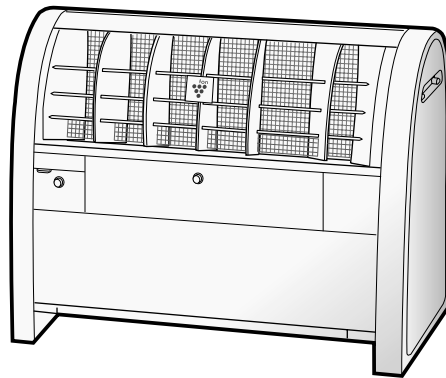

IG-A20A

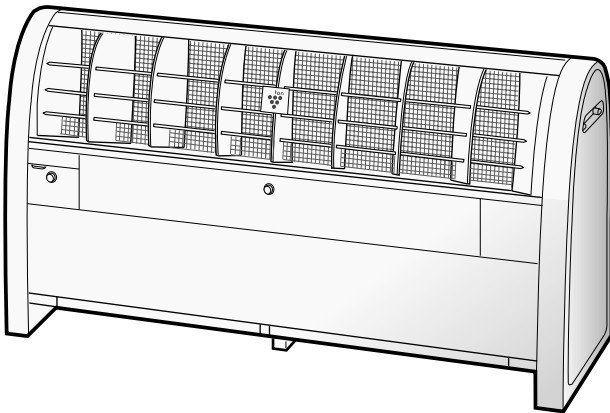

IG-A40A

Read and keep this manual carefully.
請仔細閱讀並妥善保存這本手冊。

香港電器安全規格
(國際電工委員會規格適合)

FEATURES



SHARP's Original Air Disinfecting Technology.

Plasmacluster HD helps to improve the air quality by inactivating airborne mold*1, viruses*2, allergens*3, and adhering odor*4.

1 Release Plasmacluster Ions.

Plasmacluster Ions are the same positive and negative ions found in nature. The ions are surrounded by water molecules, and are released into the air.

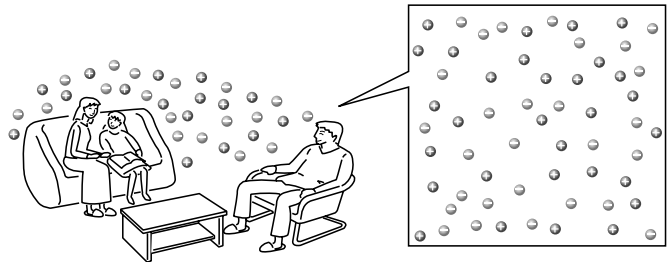

2 Attack Airborne microbes.

The ions form hydroxide radicals that are highly oxidizing only when they adhere to the surfaces of mold and viruses. They instantly remove the hydrogen from the surface proteins, breaking them down.

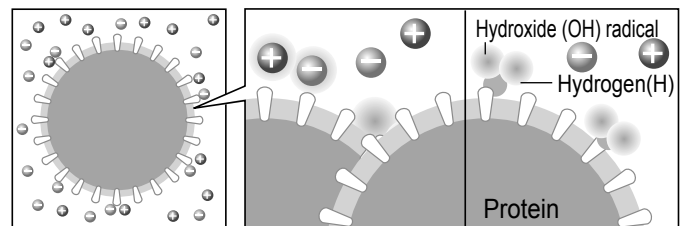

3 Return to the air as water.

The hydroxide (OH) radicals combine with hydrogen (H) to form water (H₂O) which returns to the air.

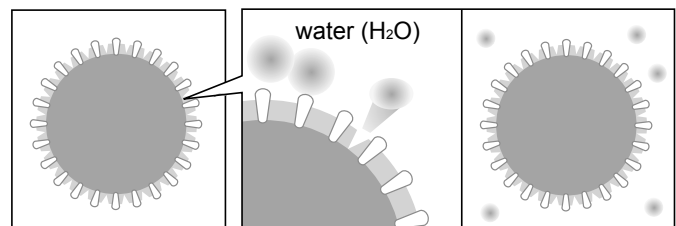

Testing and verification Organization.

*1 Ishikawa Health Service Association.

*2 Retroscreen Virology Ltd, UK.

*3 Hiroshima University.

*4 Japan Spinners Inspecting Foundation.

GLP*5-compliant test facilities have gathered highly reliable safety data on Sharp's Plasmacluster technology.

•Skin irritation/corrosion test

•Eye irritation/corrosion test

•Inhalation toxicity test (lung tissue genetic impact assessment)

Tested by: Mitsubishi Chemical Safety Institute

*5 GLP(Good Laboratory Practice) is a system of management controls for test facilities and test procedures designed to ensure the reliability of chemical safety assessment tests.

CONTENTS

IMPORTANT SAFETY INSTRUCTIONS	E-2
• WARNING	E-2
• CAUTIONS CONCERNING OPERATION	E-2
• INSTALLATION GUIDELINES	E-2
PARTS NAME	E-3
• CONTROL PANEL	E-3
• FIX THE OPERATION COVER BY SCREW	E-3
INSTALLATION POSITION	E-4
ACCESSARIES	E-4
HOW TO INSTALL THE UNIT	E-5
OPERATION	E-6
CLEANING AND MAINTENANCE	E-7
• MAIN UNIT	E-7
• FILTER	E-7
PLASMACLUSTER ION GENERATING UNIT REPLACEMENT ...	E-8
HOW TO REPLACE THE PLASMACLUSTER ION GENERATING UNIT ...	E-9
SPECIFICATIONS	E-11
TROUBLESHOOTING	E-12

- While IG-A20A and IG-A40A can inactivate suspended viruses and other contaminants, it cannot create a completely sterile environment. SHARP does not guarantee its ability to prevent microbial infection.
- To enable stable emission of high-density Plasmacluster ions, the Plasmacluster Ion Generating Unit mounted in IG-A20A and IG-A40A have to be replaced periodically*.

* Replacement is required approximately every 2 years (17,500 hours) when operated 24 hours a day. IG-A20A and IG-A40A will stop operating after about 26 months (19,000 hours) if the Plasmacluster Ion Generating Unit is not replaced.

Thank you for purchasing this SHARP Plasmacluster Ion Generator. Please read this manual carefully before using Plasmacluster Ion Generator. After reading, keep the manual in a convenient location for future reference.

IMPORTANT SAFETY INSTRUCTIONS

When using electrical appliances, basic safety precautions should be followed, including the following:

WARNING - To reduce the risk of electric shock, fire, or injury :

- Read all instructions before using the unit.
- Use only a 220 volt outlet.
- DO NOT use the unit if the power cord or plug is damaged, or the connection to the wall outlet is loosened.
- Periodically remove dust from the plug.
- DO NOT insert fingers or foreign objects into the air intake or air outlet.
- Always hold the plug and never pull on the cord when removing the power plug.
Electric shock and/or fire from a short circuit may result.
- DO NOT remove the plug when your hands are wet.
- DO NOT use the unit near gas appliances or fireplaces.
- If the power cord is damaged, it must be replaced by the manufacturer, its service agent, a Sharp authorized Service Center or qualified person in order to avoid a hazard.
- Be cautious when cleaning the unit.
Strong corrosive cleansers may damage the exterior.
- DO NOT use it in the areas where the unit may get wet.
- DO NOT use spray products near the unit.
- DO NOT use in the rooms, containing oil component, incense, cigarettes' sparks, and chemical fumes.
- DO NOT operate when using aerosol insecticides or in rooms where there is oily residue, incense, sparks from lit cigarettes, chemical fumes in the air, or in locations where the unit may get wet, such as bathroom.
- Only a Sharp authorized Service Center should service this Plasmacluster Ion Generator.
Contact the nearest Service Center for any problems, adjustments, or repairs.
- This appliance is not intended for use by persons (including children) with reduced physical, sensory or mental capabilities, or lack of experience and knowledge, unless they have been given supervision or instruction concerning use of the appliance by a person responsible for their safety.
- Children should be supervised to ensure that they do not play with the appliance.
- Do not ride on the main unit and do not sit on or lean it, it may cause injury or malfunction.

CAUTIONS CONCERNING OPERATION:

- DO NOT block the air intake and/or air outlet.
- DO NOT use the unit near or on hot objects, such as stoves or heaters or where it may come into contact with steam.
- Always operate the main unit in an upright position.
- Clean the exterior with a soft cloth only, otherwise the main unit surface may be damaged or cracked.
- Keep the main unit away from water.

INSTALLATION GUIDELINES:

- Place at least 2m away from equipment utilizing electric waves such as televisions or radios to avoid electrical interference when using the unit.
- Avoid using in locations where the unit is exposed to condensation or drastic temperature changes.
Appropriate room temperature is between 0-35°C.
- Avoid locations where grease or oily smoke is generated, otherwise the main unit surface may crack as a result.

NOTE - Radio or TV Interference:

If this Plasmacluster Ion Generator may cause interference to radio or television reception, try to correct the interference by one or more of the following measures:

- Reorient or relocate the receiving antenna.
- Increase the distance between the unit and radio/TV receiver.
- Connect the equipment into an outlet on a circuit different from that to which the receiver is connected.
- Consult the dealer or an experienced radio/TV technician for help.

PARTS NAME

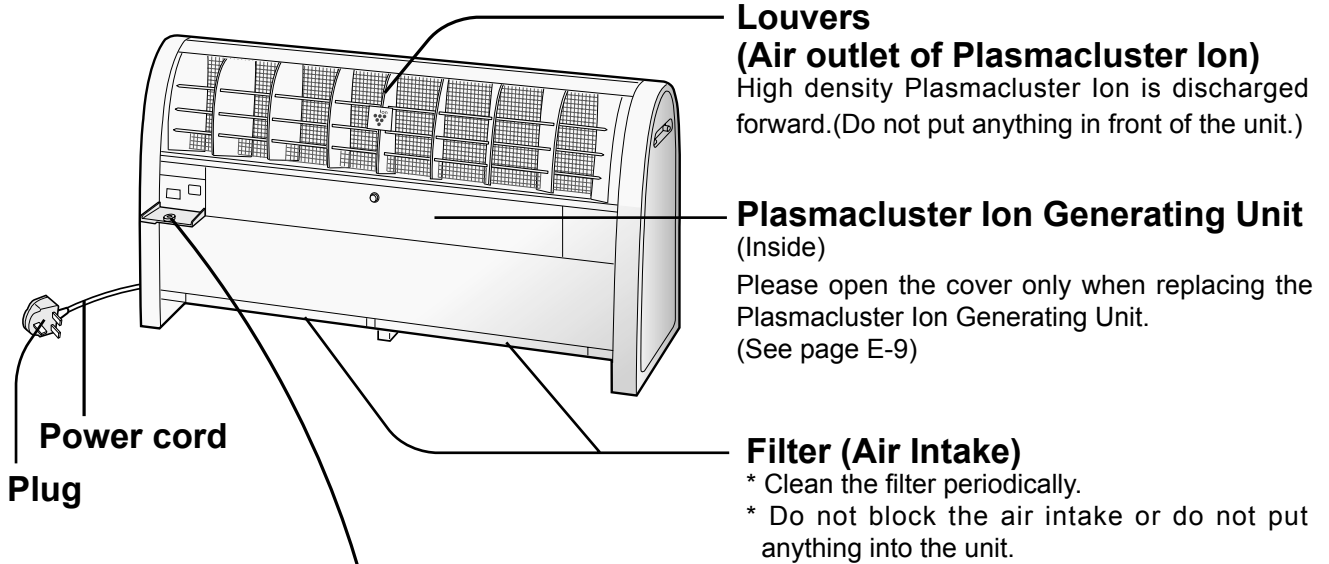

ENGLISH

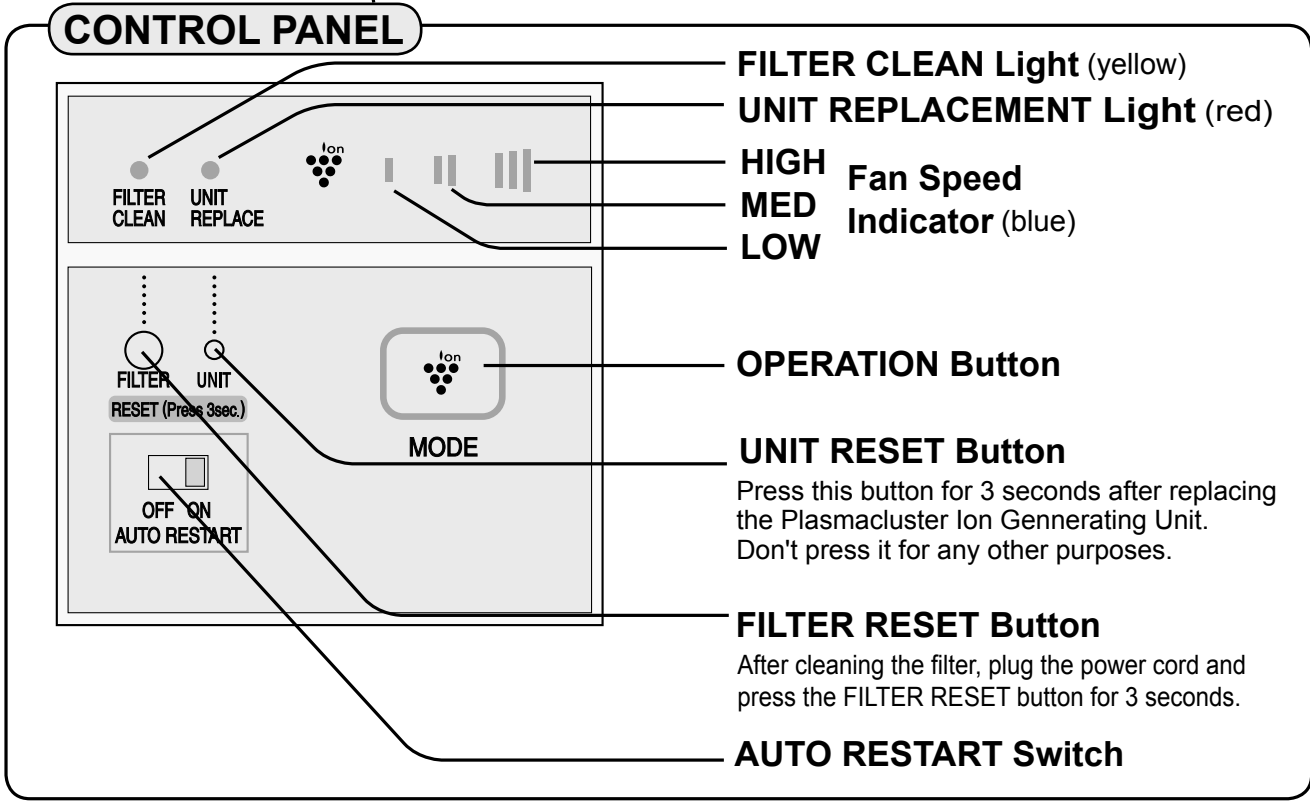

FIX THE OPERATION COVER BY SCREW

If necessary, operation cover can be fixed by accessory screw.

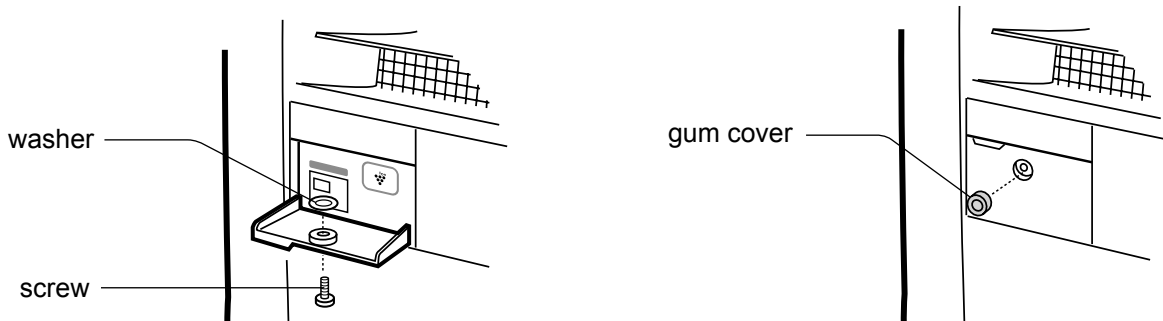

INSTALLATION POSITION

Place the main unit on a smooth, stable surface in a room, and insert the plug into an outlet.

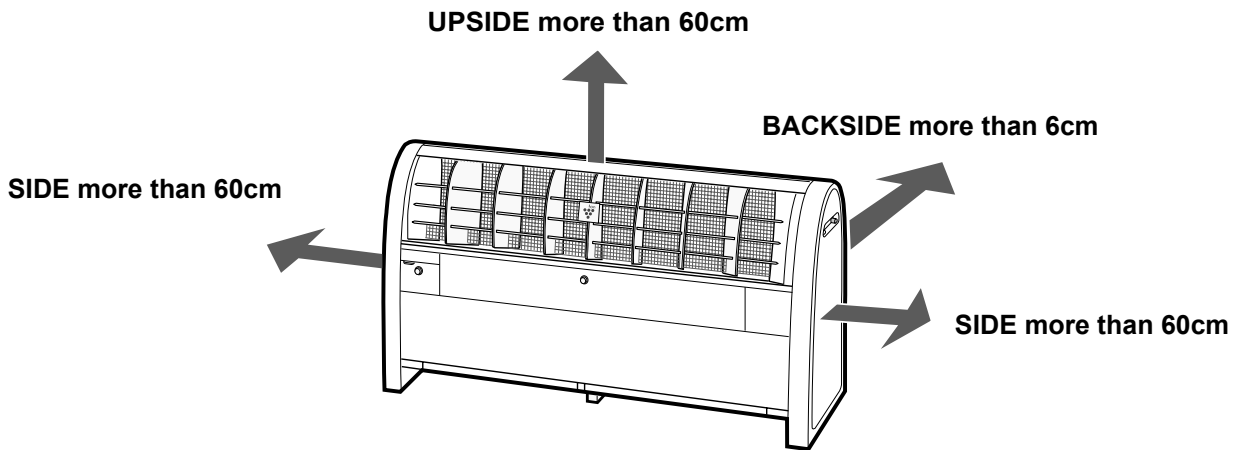

Installation Guidance

- To secure the performance, do not put anything in front of the unit.
- To secure the performance, do not block the air intake or do not put anything into the unit.
- If necessary, unit is fixed to the wall using accessory parts or fixed by anchor bolt see page E-5.

DO NOT USE the below items near the unit.
silicone-containing products*

SPRAY



WAX



PESTICIDE



*Hair care products, cosmetic products, water proof sprays, polish glass cleaner, wipe and wax.

ACCESSORIES

- Operation manual
- Tip-resistant kit
- Screw kit

Tip-resistant kit

(In case of fixing the main unit to the wall)

mounting parts for wall
(2pcs)

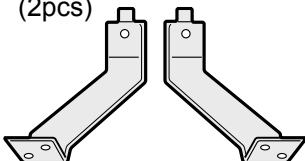

screw for the
main unit (2pcs)



Screw kit for operation cover

screw (1pc)

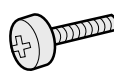

gum cover (1pc)



washer (1pc)



Anchor bolt, nut, and washer for fixing to the floor and screw for the wall for fixing to the wall are not included as accessory parts.

HOW TO INSTALL THE UNIT

- 1** Unscrew the painted screws (2 pcs on each side).

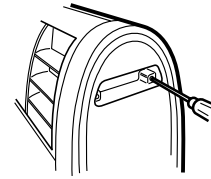

- 2** Lift up the Side Panel and remove it outward.

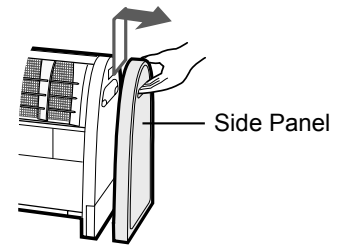

- 3** **In case of fixing the main unit to the floor by anchor bolts.**

Measure the position of the anchor bolts and fix them to the floor.

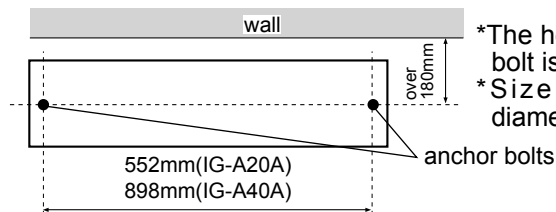

*The height of the anchor bolt is 25mm or less.

*Size of anchor bolt diameter is 8mm or less.

Put the main unit on the anchor bolts and tighten surely with washer and nut.

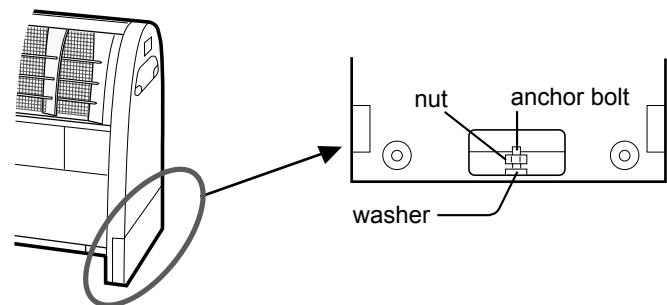

- In case of fixing the main unit to the wall with the mounting parts.**

Fix the mounting parts to the main unit by screws. (Right and left side)
The mounting parts and screws are accessory parts. (Each 2 pcs)

Screws are to be surely tightened.

*Depending on the material of the wall, it may not be able to tighten.

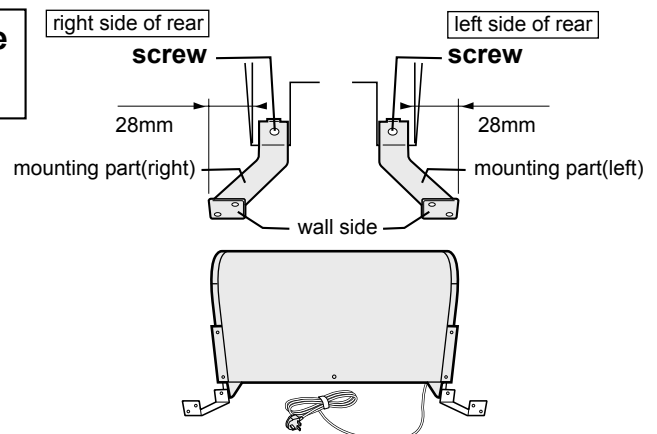

- 4** Attach the Side Panel and screw the painted screws on both sides.

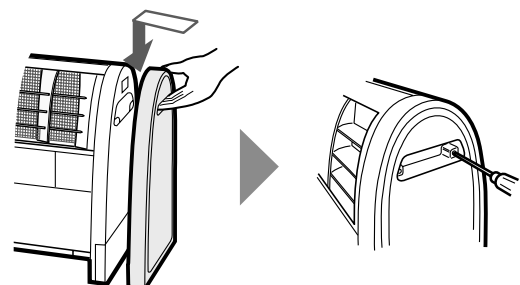

OPERATION

*This operation manual is based on IG-A40A.
The operation is same as IG-A20A.

Open the cover of Control Panel.

In case that the cover is fixed by a screw, take out the gum cover and a screw, and open the cover of control panel.

Fix the cover of Control Panel.

As necessary, screw down the cover with the provided screw and the washer and fit in the gum cover.
(Please see Page E-3)

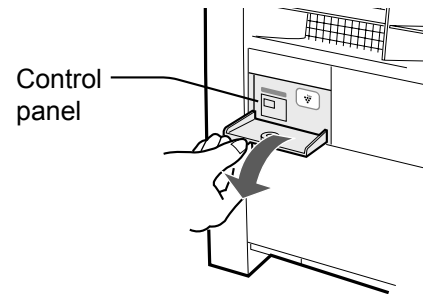

Press the Operation Button to select the preferred mode.

The diagram shows a control panel with an 'Ion' logo and three vertical bars. Below it is a button labeled 'MODE' with an 'Ion' logo and a hand icon. A line connects this button to a larger box containing mode selection options:

LOW I	Release high-density Plasmacluster ions quietly.
MED II	Release high-density Plasmacluster ions at medium fan speed.
HIGH III	Increase the volume of high-density Plasmacluster ions to increase the purifying capacity.
Power 'OFF'	

OPERATION BUTTON

AUTO RESTART

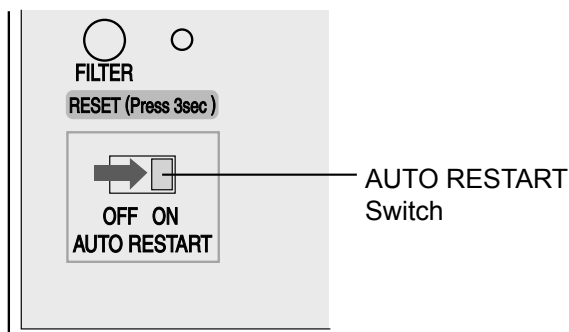

If the AUTO RESTART switch sets "ON" and then the product is accidentally unplugged or the breaker trips during use, it automatically starts operating with previous mode after electric reset.

CLEANING AND MAINTENANCE

WARNING:

When cleaning the unit, be sure to first unplug the power cord, and never handle the plug with wet hands.

Electric shock and/or bodily injury may occur as a result.

Main Unit

Every month or more often if necessary.

Wipe with a dry soft cloth.

<For Stubborn Dirt>

Use water and a mild detergent.

And then, wipe with a wet cloth.

Make sure to dry out .

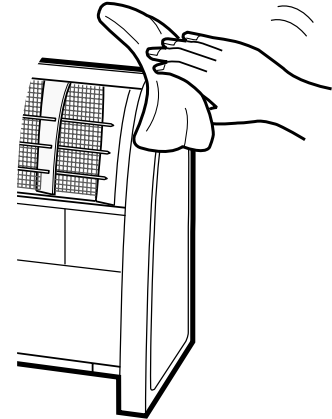

ENGLISH

FILTER

Every 2 weeks or more often if necessary.

FILTER CLEAN Light will be lit after approx. 1 month(approx.720 hours), when operated 24 hours a day.

Pull out the filter from bottom of the main unit and remove dust by using a vacuum cleaner or similar tools.

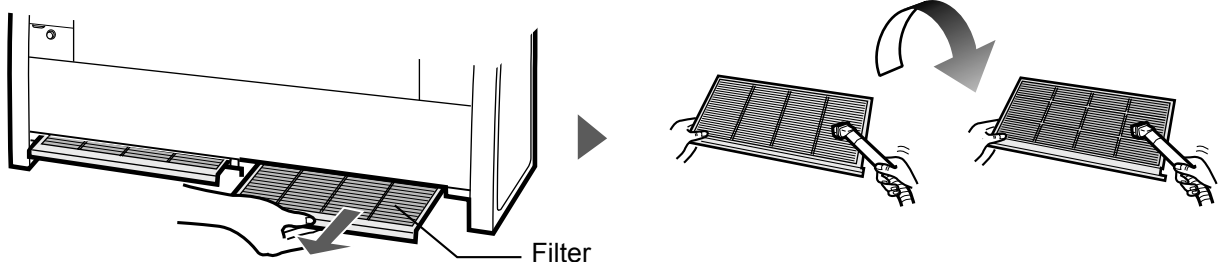

IG-A20A Filter (1pc)

IG-A40A Filter (2pcs)

*A filter is not disposable item, often clean the filter.

- When the filter is very dirty, please wash with water or using mild kitchen detergent.

CAUTION

- Do not rub with a hard sponge and do not bend it when washing.
- Avoid drying filters outdoors under sunlight or using near a stove.

FILTER RESET Button

After cleaning, insert the plug and press RESET Button for 3 seconds.

PLASMACLUSTER ION GENERATING UNIT REPLACEMENT

In order to release Plasmacluster Ion stably, periodical replacement of Plasmacluster Ion Generating Unit is necessary. The Unit Replacement Light will be ON as a reminder for replacement.

Elapsed Time	Display	Message
Beginning to use.	<p>The display shows a solid dot for 'FILTER CLEAN', a solid dot for 'UNIT REPLACE', an 'Ion' symbol, and a blue light indicator (represented by a starburst) that is lit. A dashed box encloses the 'UNIT REPLACE' indicator and the blue light indicator.</p>	Operate normally
Approx. 2 years. (approx. 17,500hours)	<p>The 'UNIT REPLACE' indicator is flashing red. The blue light indicator is lit. A dashed box encloses the blue light indicator.</p>	Suggest replacing
Approx. 2 years and 2 months. (approx.19,000hours)	<p>The 'UNIT REPLACE' indicator is flashing faster red. The blue light indicator is off.</p>	<ul style="list-style-type: none"> •Stop working •Replace the Plasmacluster Ion Generating Unit.
Plasmacluster Ions are not released.	<p>The 'UNIT REPLACE' indicator is flashing red. The blue light indicator is flashing blue. A dashed box encloses the blue light indicator.</p>	Error*

*Usage environment affects the lifetime of the Plasmacluster Ion Generator. The Plasmacluster Ion Generator may stop working before estimated lifetime. In this case, press Operation Button again and restart. If this does not help, replace with a new Plasmacluster Ion Generating Unit.

Plasmacluster Ion Generating Unit for Replacement

Plasmacluster Ion Generating Unit	
Model Number	IZ-CA40E(for IG-A40A) IZ-CA20E(for IG-A20A)

<For Disposal>

Please dispose the used Plasmacluster Ion Generating Unit according to any local laws and regulations.

-materials-

- Case:Acrylonitrile Butadiene Styrene (ABS)
- Unit:Polybutylene Terephthalate(PBT),Electric parts.

HOW TO REPLACE THE PLASMACLUSTER ION GENERATING UNIT

*When replacing the Plasmacluster Ion Generating Unit, be sure to turn off the main unit, unplug the power cord, and never handle the plug with wet hands.

- 1** Remove the gum cover and unscrew the center screw of the Ion Generator Cover.

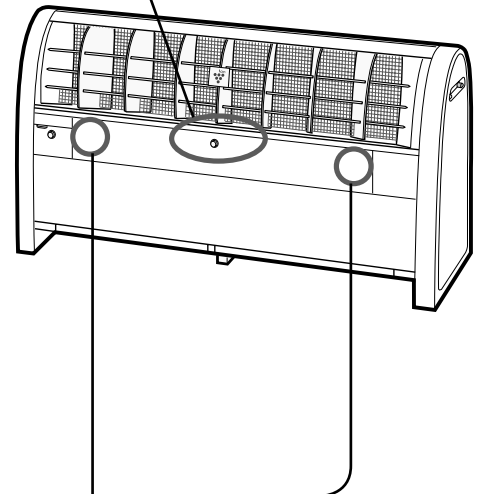
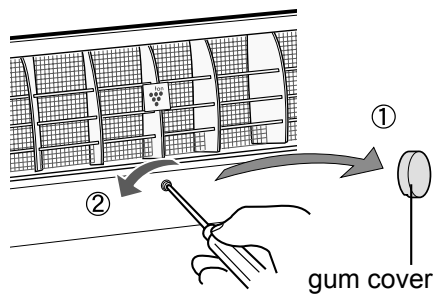

- 2** Push the both corner of Ion Generator Cover and open it. (IG-A40A only)

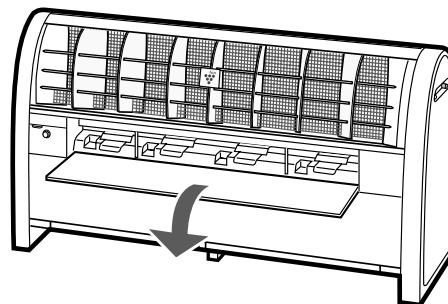
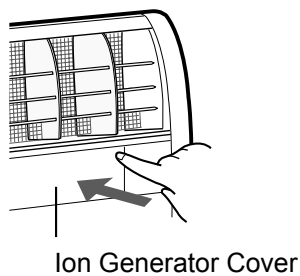

(see next page)

HOW TO REPLACE THE PLASMACLUSTER ION GENERATING UNIT

3

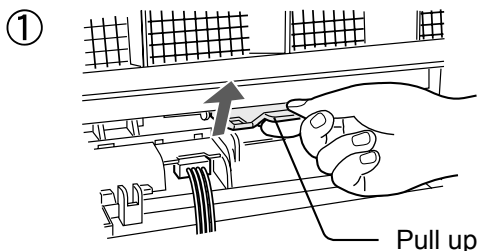

① Pull up the lever in the direction of the arrow to unlock it.

Pull up the lever

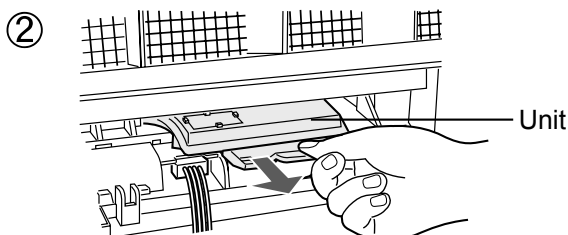

② Pull the lever in the direction of the arrow and take out the Plasmacluster Ion Generating Unit.

Unit

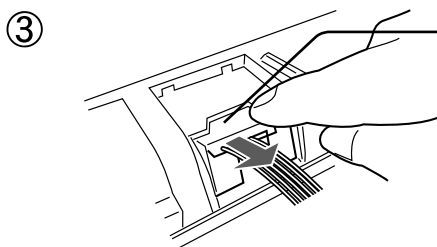

③ Remove the connector cover.
(IG-A40A only : 4 pcs)

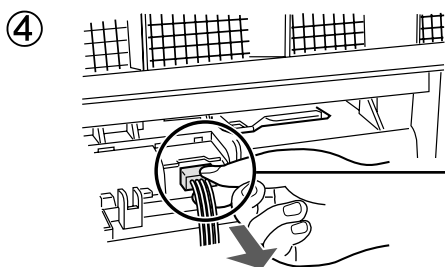

④ Disconnect the connector of Plasmacluster Ion Generating Unit.

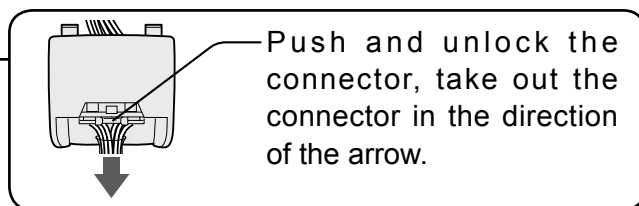

Push and unlock the connector, take out the connector in the direction of the arrow.

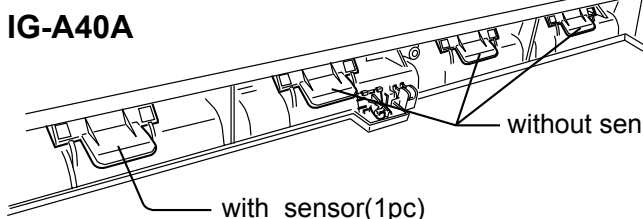
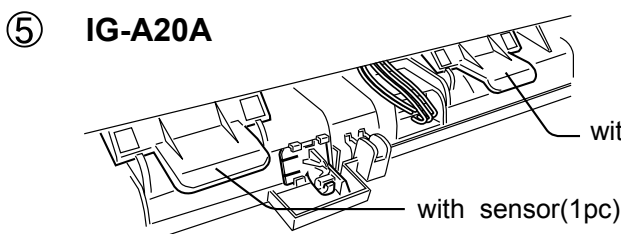

Plasmacluster Ion Generating Unit without sensor.
IG-A20A : 1pc
IG-A40A : 3pcs

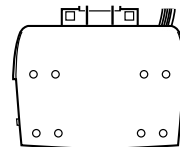

Plasmacluster Ion Generating Unit with sensor.
IG-A20A : 1pc
IG-A40A : 1pc

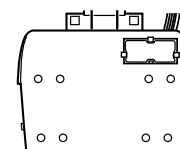

Reset button for Plasmacluster Ion Generating Unit

After replacing the Plasmacluster Ion Generating Unit, insert the plug and press the UNIT RESET Button for 3 seconds.

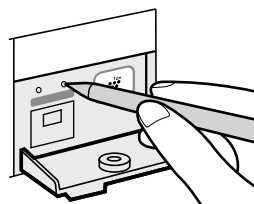

SPECIFICATIONS

Model	IG-A20A			IG-A40A		
Power supply	220V, 50Hz					
Fan speed	HIGH	MED.	LOW	HIGH	MED.	LOW
Power consumption(W)	22	14	9	39	20	10
Operating noise level(dBA)	45	40	34	47	40	34
Airflow volume(m ³ /hour)	468	390	306	840	648	510
Applicable floor surface area(m ²) *1	23			50		
Ion density(ions/cm ³) *2	25,000	12,000	7,000	25,000	12,000	7,000
Power cord(m)	2.0					
Outer dimensions(mm)	594(W)×480(H)×230(D)			940(W)×480(H)×230(D)		
Weight(kg)	10.5			15.0		

*1 The target floor surface area for which an emitted airborne ion density of about 25,000 ions/cm³ can be measured at a point near the center of the room (at a height of about 1.2m from the floor), during operation at the HIGH mode when the main unit is placed near a wall.

*2 Ions, counted per cm³, blown into air near the center of the room (at a height of approx. 1.2m from the floor) during operation at each airstream setting when the main unit is placed near the wall.

•The number of ions will vary according to the room conditions and operation mode.





Standby Power

In order to operate the electrical circuits while the power plug is inserted in the wall outlet, this product consumes about 0.8W of standby power.

For energy conservation, unplug the power cord when the unit is not in use.

TROUBLESHOOTING

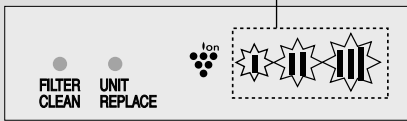
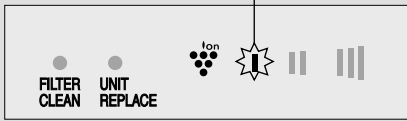
Before calling for service, please review the TROUBLESHOOTING chart below. Since the problem may not be unit malfunction.

Problem	WHAT TO DO
<p>The Plasmacluster Ion Generator does not work.</p> <hr/> <p>flashing faster (red)</p>  <hr/> <p>flashing (red) flashing (blue)</p>  <hr/> <p>flashing (blue)</p>  <p>flashing (blue)</p> 	<p>Make sure to put in the plug.</p> <hr/> <p>Approx 2 years and 2 months (approx. 19,000 hours) has been passed. Replace with a new Plasmacluster Ion Generating Unit. See page E-8,9.10.</p> <hr/> <p>Plasmacluster Ions are not released. Press the Operation Button and restart.</p> <p>If all lights keep flashing, replace with new Plasmacluster Ion Generating Unit. See page E-8,9.10.</p> <ul style="list-style-type: none"> •Dust may block the filter, clean the filter. <hr/> <p>Failure Unplug and ask the store you purchased or Sharp Service Center.</p>
<p>The discharged air has odor.</p>	<p>The Plasmacluster Ion Generator releases a small trace of ozone which may produce odor. This is not detrimental to health.</p>
<p>A clicking or ticking sound comes from the unit while operating the Plasmacluster Ion Generator.</p>	<p>Loudness can be changed depending on a room humidity, but the effectiveness is the same. Relocate the Plasmacluster Ion Generator if necessary.</p>
<p>Lighting (yellow)</p>  <hr/> <p>A discontinuous noise is heard. The air flow decreases.</p>	<p>Filter cleaning time. See page E-7. After cleaning the filter, press FILTER RESET Button for 3 seconds.</p> <hr/> <p>Filter is getting dirty. Clean the filter. After cleaning the filter, press FILTER RESET Button for 3 seconds.</p>

目錄

重要安全事項	C-2
• 警告	C-2
• 操作注意事項	C-2
• 安裝指南	C-2
各部分名稱	C-3
• 操作面板	C-3
• 用螺絲緊固操作蓋板	C-3
安裝位置	C-4
附件	C-4
如何安裝主機	C-5
主機操作	C-6
保養與清潔	C-7
• 主機	C-7
• 過濾網	C-7
HD 離子產生器的更換	C-8
如何更換 HD 離子產生器	C-9
規格	C-11
故障時的解決方法	C-12

• 雖然 IG-A20A 和 IG-A40A 能夠抑制和去除懸浮的病毒以及其他污染物，但並不能夠營造一個完全無菌的環境。聲寶公司對該產品防止微生物感染的能力不提供保證。

• 為穩定釋出高密度的離子簇，需要定期更換安裝於 IG-A20A 和 IG-A40A 內部的 HD 離子產生器*。

* 在 24 小時連續運行的情況下，大約每 2 年（17,500 小時）需要進行一次更換；如果未對 HD 離子產生器進行更換，IG-A20A 和 IG-A40A 將在大約 26 個月（19,000 小時）後停止運行。

感謝您購買聲寶公司生產的 HD 離子簇抗菌機。在使用 HD 離子簇抗菌機前，請詳細閱讀本手冊。
閱讀後請妥善保存本手冊，便於今後查閱。

重要安全事項

在使用電器產品時，必須遵守基本安全預防措施，包括以下各方面：

警告 - 為減少觸電、火災或受傷等危險：

- 在使用本機前詳細閱讀所有的注意事項。
- 只可使用 220V 的電源插座。
- 在電源線或電源插頭發生損壞、或是牆壁上的電源插座發生鬆脫的情況下，切勿使用本機。
- 定期清除電源插頭上的灰塵。
- 切勿將手指或異物插入空氣吸入口或吹出口。
- 在拔出電源插頭時，必須緊握插頭，切勿拉扯電源線。
否則可能會因短路而導致觸電和 / 或火災的發生。
- 手濕時請勿拔插電源插頭。
- 切勿在氣體設備或壁爐附近使用本機。
- 如果電源線損壞，必須由製造廠商、其服務代理商、聲寶公司授權的服務中心或其他具有同樣資格的人員進行更換，以避免發生危險。
- 清潔本機時應小心謹慎。
強烈的腐蝕性清潔劑會對本機表面造成損害。
- 切勿在可能會導致本機發潮的場所使用。
- 切勿在本機附近使用噴霧產品。
- 切勿在含有石油成分、焚香煙霧、香煙火苗及化學性煙霧的房間內使用本機。
- 當使用噴霧殺蟲劑時，請勿使用本機。
- 只有聲寶公司授權的服務中心方可對本機進行維修。
遇到任何問題或是需要對產品進行調整、修理時，請與就近的服務中心聯繫。
- 除非得到監護人或負責其安全人士的適當監督或指導，否則，本機不適合身體官能或心智能力退化者，或缺乏操作經驗和知識的人士（包括兒童）使用。
- 兒童應受到適當的監管，以確保不會以此機器作玩具。
- 切勿攀爬到主機上，切勿坐於其上或使其傾斜，否則可能會導致傷害或故障。

操作注意事項

- 切勿阻塞空氣吸入口和吹出口。
- 切勿在高溫物體（例如爐灶或暖爐等）上或其附近、或是在可能會接觸到水蒸氣的場所使用本機。
- 使用時應確保其處於直立狀態。
- 只能使用柔軟的布料清潔本機表面，否則可能導致本機表面損壞或發生破裂。
- 確保本機遠離水源。

安裝指南

- 本機的擺放位置應與電視機、收音機等應用電磁波的設備距離至少 2 米以上，以避免在使用本機時發生電波干擾。
- 請勿安裝在由於溫度劇烈變化而導致本機直接暴露於冷凝環境的地方。只適宜在 0-35°C 之間的室溫下使用。
- 避免在會產生油脂或含油煙霧的場所使用本機，否則可能導致本機表面損壞或破裂。

注意：收音機或電視機干擾

如果本機對收音機或電視機的信號接收造成干擾，請嘗試以下列其中一項或多項措施來修正干擾：

- 改變接收天線的方向或擺放位置。
- 增加本機與收音機 / 電視機接收器之間的距離。
- 將本機與接收器分別連接至不同的電源插座或供電線路。
- 向經銷商或有經驗的收音機 / 電視機技術人員諮詢並請求幫助。

各部分名稱

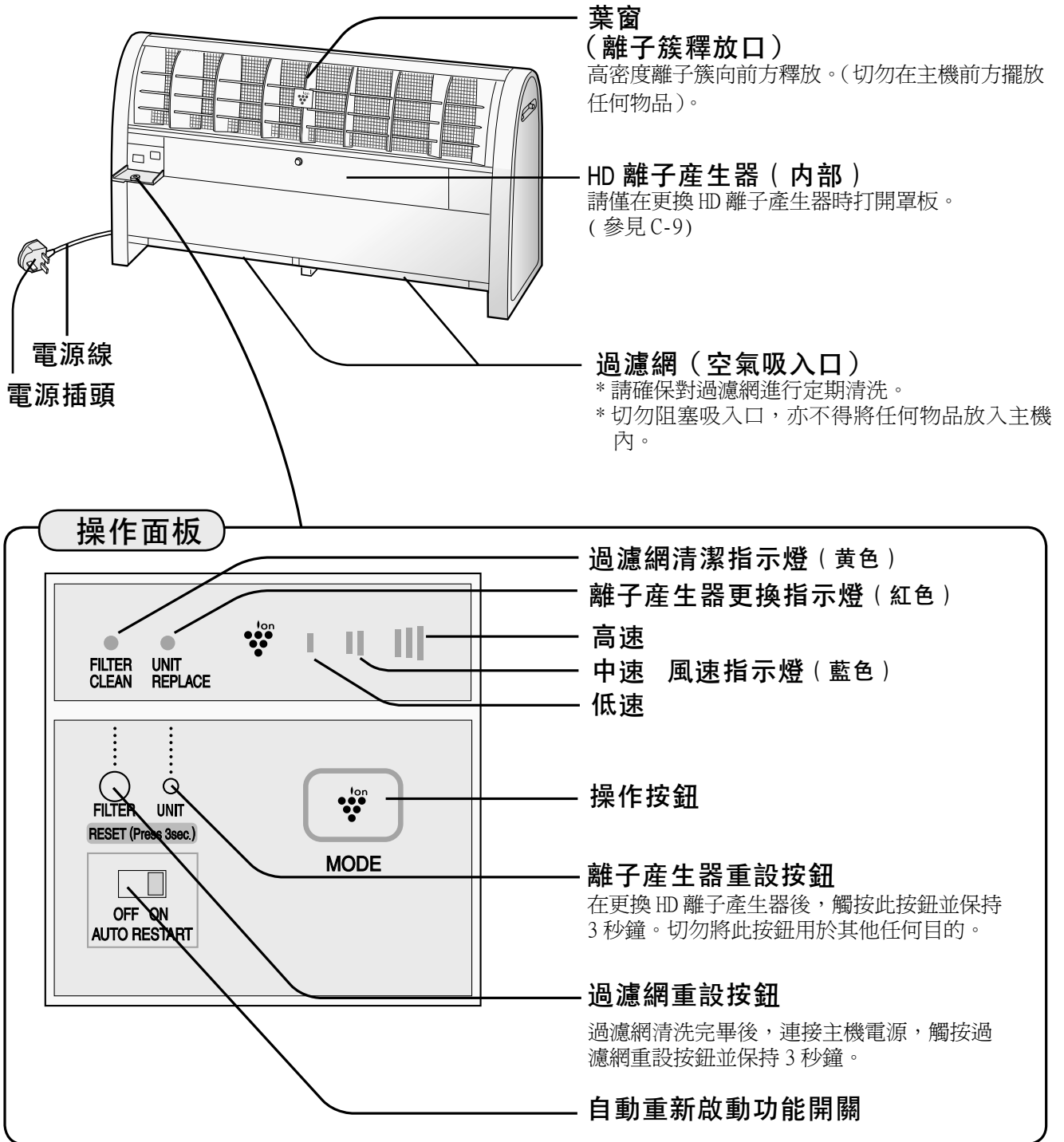

中文

用螺絲緊固操作蓋板

必要時，可以使用附帶的螺絲對操作蓋板進行緊固。

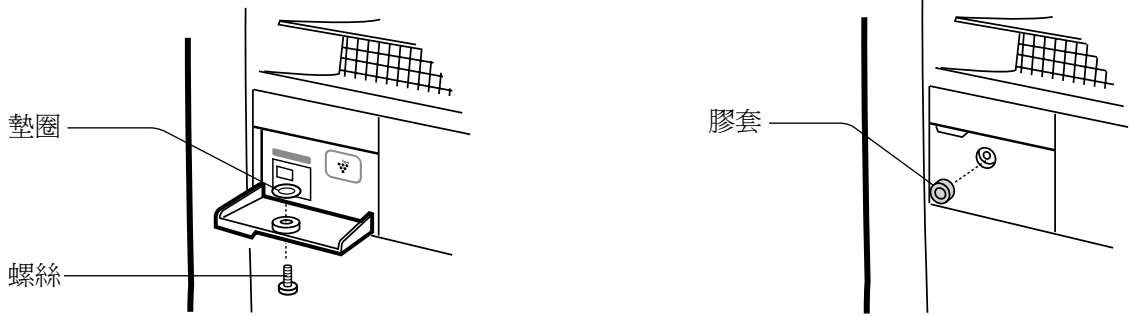

安裝位置

擺放本機在房間內一個平滑、穩定的地方，並將插頭插入電源插座中。

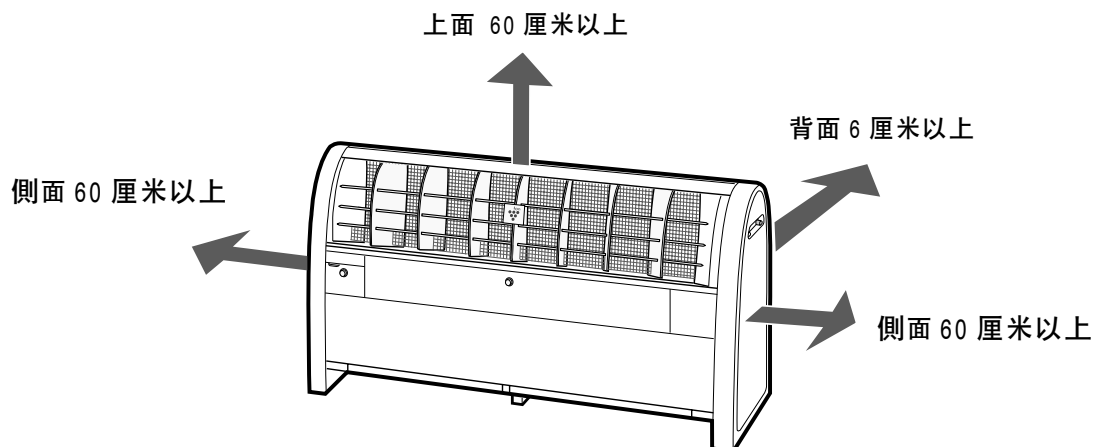

安裝指南

- 為確保主機性能，切勿在其前方放置任何物品。
- 為確保主機性能，切勿阻塞空氣吸入口，亦不得將任何物品放入主機內。
- 如有需要，可以使用附帶零件將主機固定在牆壁上，或是用地腳螺栓進行固定，請參見 C-5 頁。

在本機附近切勿使用下列物品。

含有矽樹脂的產品 *

噴霧劑



蠟



殺蟲劑

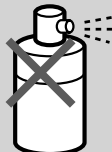

* 頭髮護理產品、化妝品、防水噴霧劑、玻璃清潔劑、光蠟等。

附件

- 使用說明書
- 套裝防傾倒工具
- 套裝螺絲

套裝防傾倒工具

(將主機固定至牆壁時)

牆壁安裝組件 (2 件)

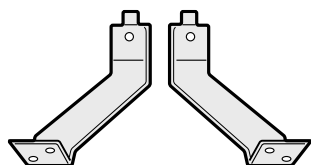

主機用的螺絲 (2 顆)

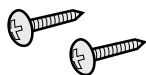

用於操作蓋板的螺絲工具

螺絲 (1 顆)



膠套 (1 個)



墊圈 (1 個)



附件中不含用於固定至地上的地腳螺栓、螺帽和墊圈，也不含用於固定至牆壁的螺絲。

如何安裝主機

1 鬆開著色的螺絲 (兩側各有 2 顆)

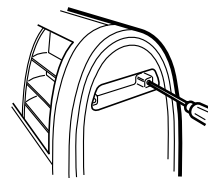

2 提起側面板並將其取出。

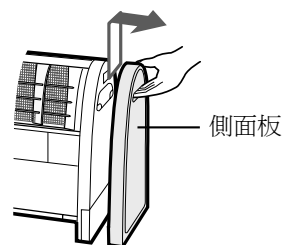

3 需要使用地腳螺栓將主機固定至地板時

測定地腳螺栓的位置，並將其固定在地板上。

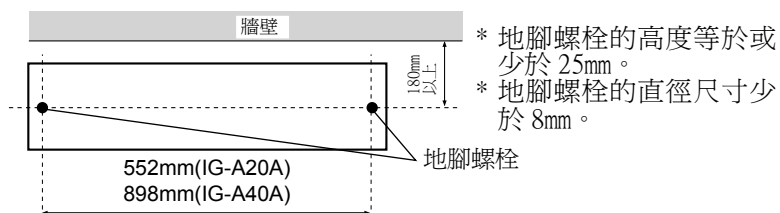

將主機放置於地腳螺栓上，並使用墊圈和螺帽切實繫穩。

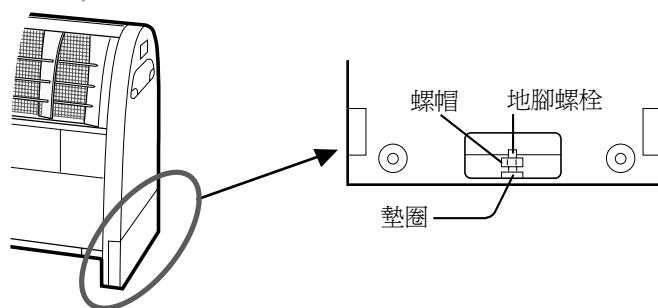

需要使用牆壁安裝組件將主機固定至牆壁時

使用螺絲，將牆壁安裝組件固定在主機上。(右面和左面)
牆壁安裝組件和螺絲是共用零件。(每個牆壁安裝組件配 2 顆螺絲)

請確保螺絲已繫穩。

* 根據牆壁材質的不同，可能會無法繫穩。

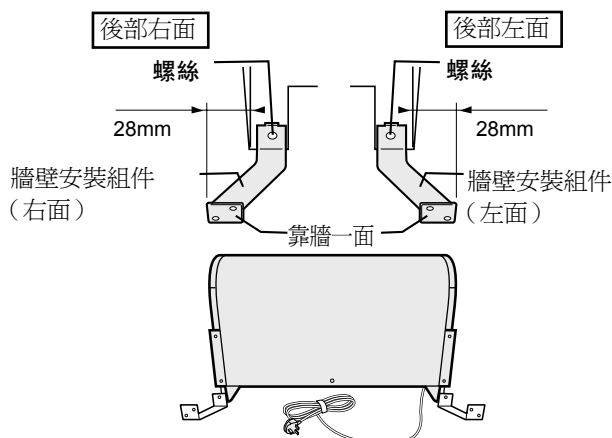

4 將側面板裝回，並扭緊兩側的螺絲。

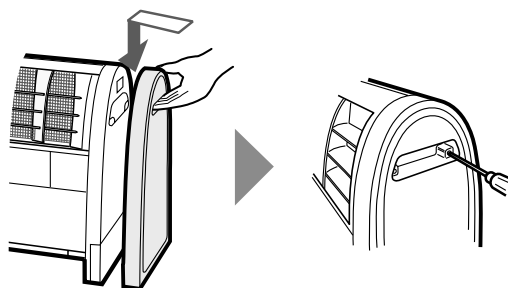

主機操作

* 本使用說明書是根據 IG-A40A 型產品所編寫。
具體操作與 IG-A20A 型產品相同。

打開操作面板蓋板。

若蓋板已被螺絲緊固，請除去膠套和鬆開螺絲，打開操作面板蓋板。

緊固操作面板蓋板。

必要時，使用附帶的螺絲和墊圈將蓋板繫穩，然後裝配好膠套。(請參見 C-3 頁)

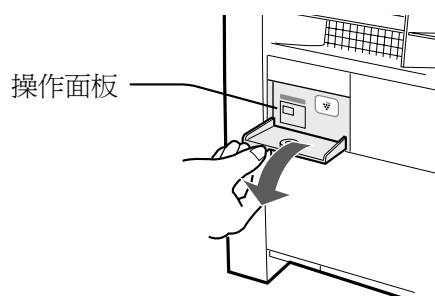

觸按操作按鈕以選擇所需的模式。

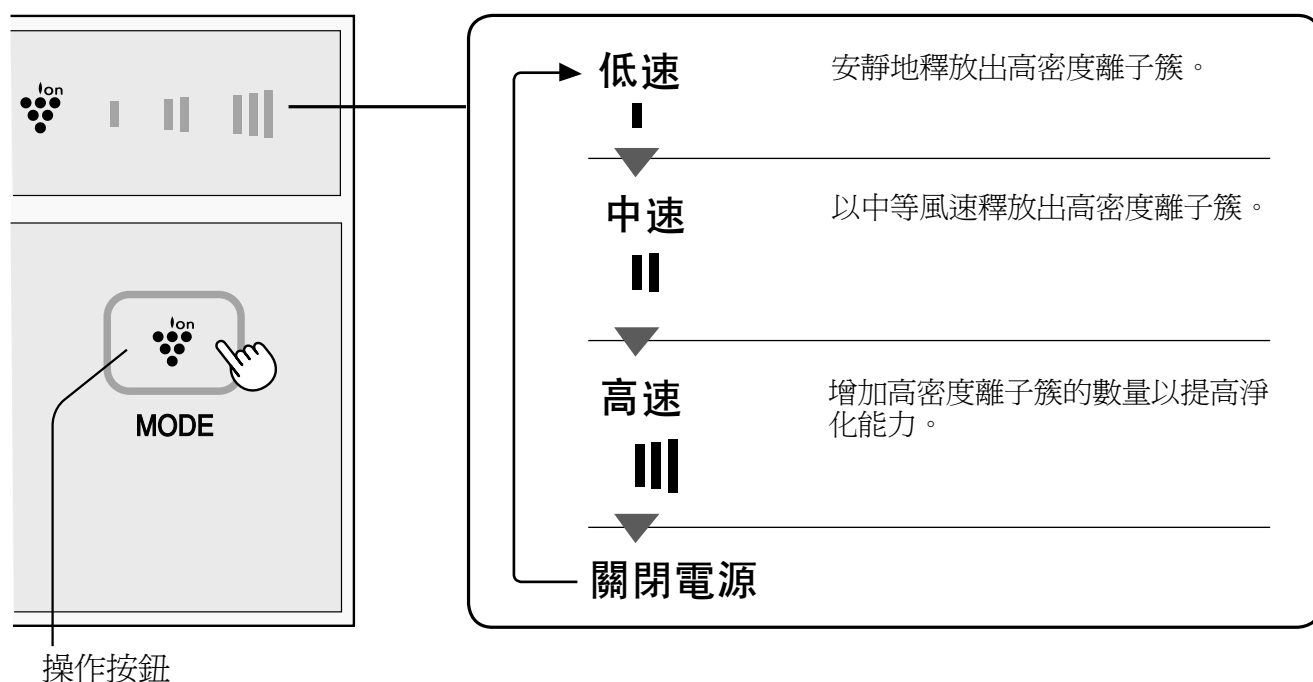

自動重新啟動功能

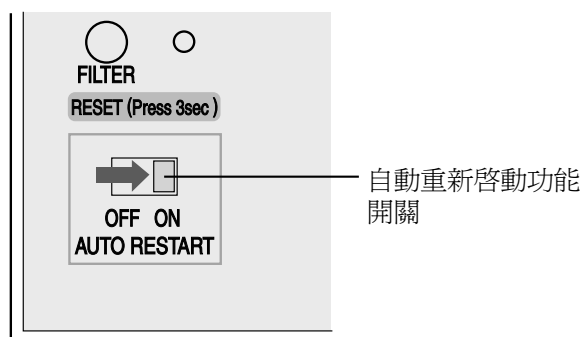

如果自動重新啟動功能開關設置為“ON (開)”，當主機電源插頭意外脫落，或是斷路器在使用過程中發生故障時，在恢復供電之後，主機會自動啟動並以斷電前的操作模式繼續操作。

保養與清潔

警告：

當對本機進行清潔時，首先應確認已經拔除電源線，切勿以濕手插拔電源插頭。否則可能會導致觸電和 / 或人身傷害。

主機

每月一次

用乾燥而柔軟的布料進行擦拭。

< 對於難處理的污漬 >

使用清水和柔和的清潔劑，然後用濕布進行擦拭。
應確保抹乾機身表面。

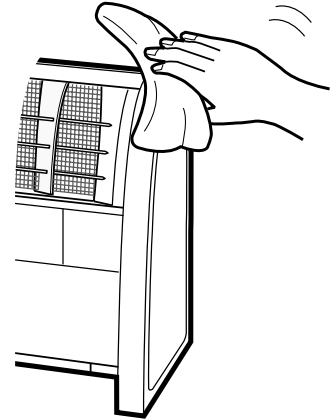

過濾網

每 2 星期一次

在 24 小時連續運轉的情況下，使用大約 1 個月（約 720 小時）之後，過濾網清潔指示燈將會亮起。從主機底部拉出過濾網，以吸塵機的吸咀或類似工具吸除灰塵。

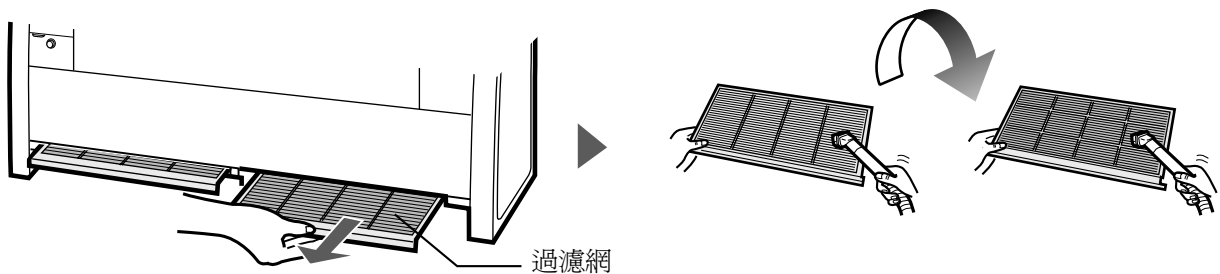

IG-A20A 過濾網 (1 個)

IG-A40A 過濾網 (2 個)

* 過濾網並非一次性使用的物品，應經常對其進行清洗。

- 當過濾網變得非常髒的時候，請用清水或中性的廚房清潔劑進行清洗。

注意

- 切勿使用硬海綿進行刮擦，在清洗時也切勿將其屈曲。
- 避免於戶外日光下對過濾網進行晾曬，或在火爐旁邊使用。

過濾網重設按鈕

清洗完畢後，插入電源插頭，觸按過濾網重設按鈕並保持 3 秒鐘。

HD 離子產生器的更換

為穩定釋出離子簇，需要定期更換 HD 離子產生器。更換指示燈將會點亮，以提示需要更換。

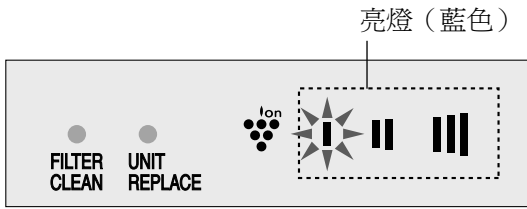
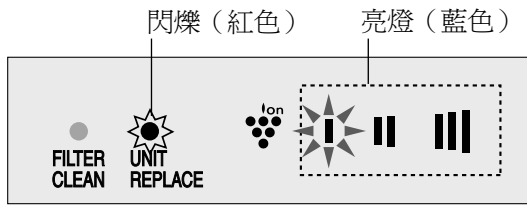
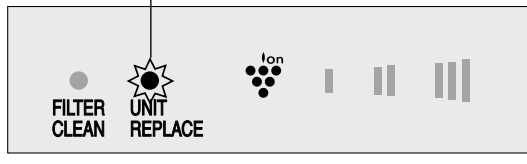
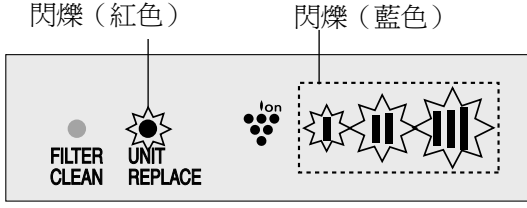
使用時間	顯示	資訊
開始使用	 <p>亮燈（藍色）</p>	操作正常
大約 2 年 (大約 17,500 小時)	 <p>閃爍（紅色） 亮燈（藍色）</p>	建議更換
大約 2 年零 2 個月 (大約 19,000 小時)	 <p>更快速地閃爍（紅色）</p>	<ul style="list-style-type: none"> • 停止操作 • 請更換 HD 離子產生器
不能釋出離子簇	 <p>閃爍（紅色） 閃爍（藍色）</p>	故障 *

* 使用環境會影響本機的使用壽命。
本機可能會在到達預計的使用壽命之前停止操作。
在這種情況下，請按下“操作按鈕”以重新啓動本機。
如果上述操作均無效，則應更換一個新的 HD 離子產生器。

HD 離子產生器的更換

HD 離子產生器	
型號	IZ-CA40E(用於 IG-A40A) IZ-CA20E(用於 IG-A20A)

< 廢棄處置 >

請嚴格遵循當地法律的相關規定對失效的 HD 離子產生器進行廢棄處置。

—材料—

- 外殼：丙烯腈 - 丁二烯 - 苯乙烯共聚物 (ABS)
- 元件：聚對苯二甲酸乙二酯 (PBT)，電器零件

如何更換 HD 離子產生器

* 當更換 HD 離子產生器時，首先應確認已經關閉電源和拔除電源線，切勿以濕手插拔電源插頭。

- 1 移除膠套並鬆開 HD 離子產生器蓋板的中央螺絲。

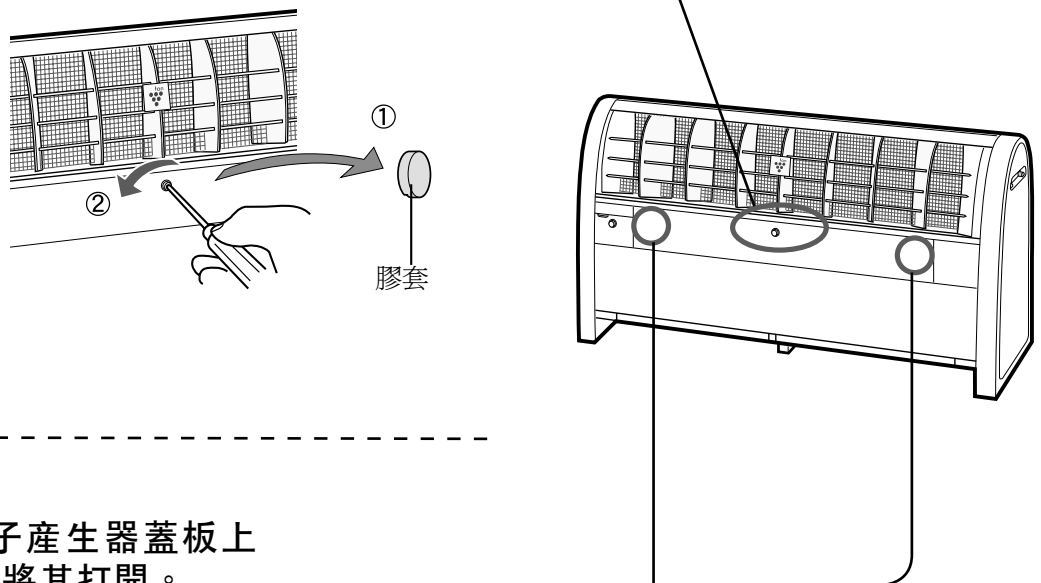

- 2 推按 HD 離子產生器蓋板上方的兩個角將其打開。
(只適用於 IG-A40A)

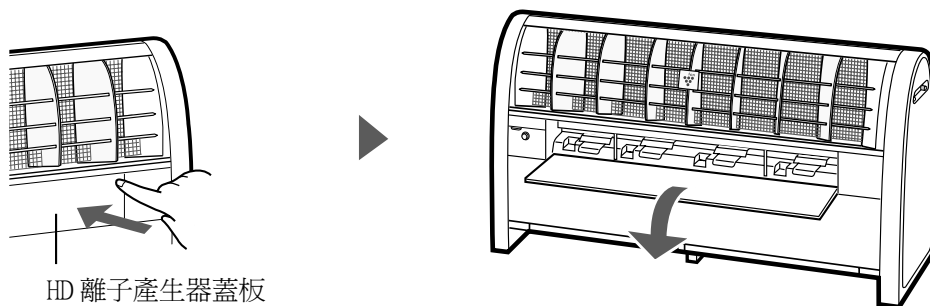

(請參看下頁)

如何更換 HD 離子產生器

3

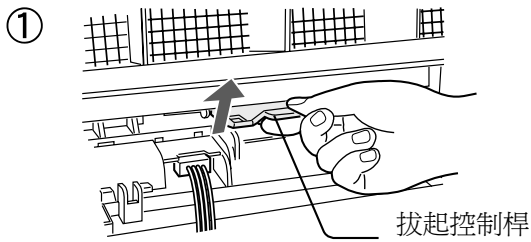

按照箭頭指示的方向拔起控制桿，解除鎖定。

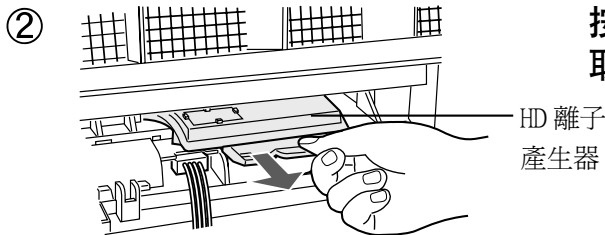

按照箭頭指示的方向拉出控制桿，並取出 HD 離子產生器。

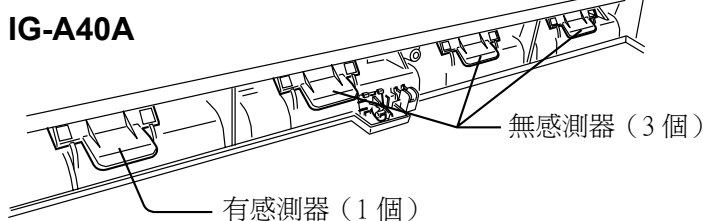
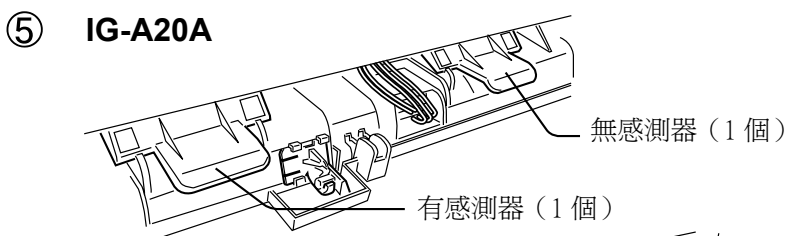
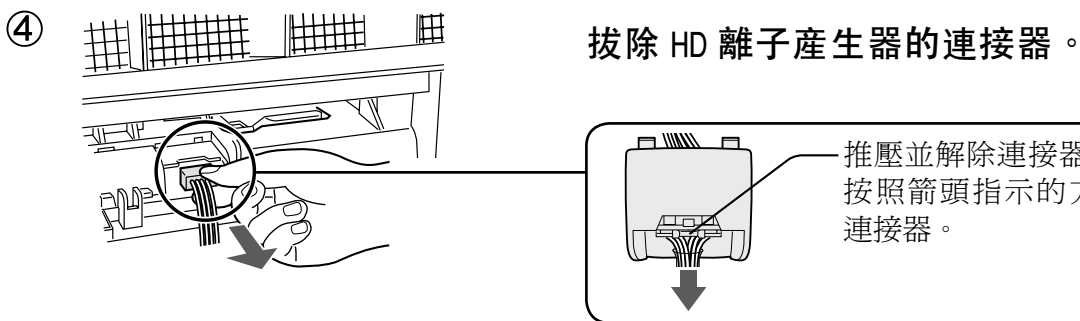
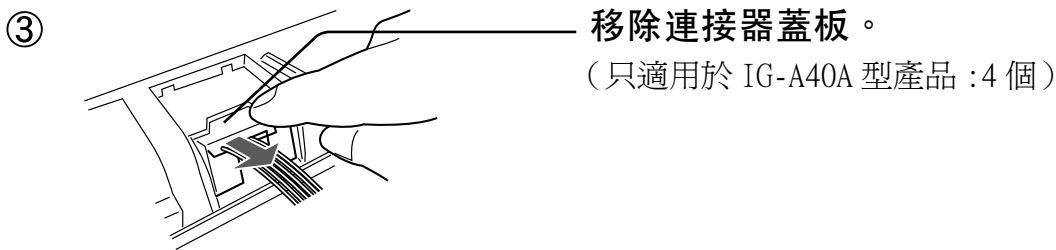

無感測器的 HD 離子產生器。
IG-A20A: 1 個
IG-A40A: 3 個

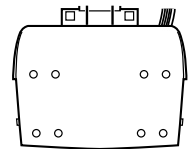

有感測器的 HD 離子產生器。
IG-A20A: 1 個
IG-A40A: 1 個

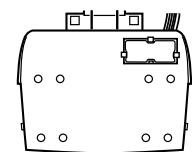

離子產生器的重設按鈕

HD 離子產生器更換完畢後，插上電源插頭，觸按離子產生器重設按鈕並保持 3 秒鐘。

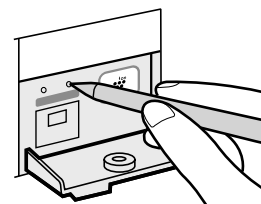

規格

型號	IG-A20A			IG-A40A		
電源	220V, 50Hz					
風速	高速	中速	低速	高速	中速	低速
額定功率 (瓦)	22	14	9	39	20	10
噪音 (分貝)	45	40	34	47	40	34
空氣流量 (立方米 / 小時)	468	390	306	840	648	510
適用面積 (平方米) *1	23			50		
離子簇濃度 (顆 / 立方厘米) *2	25,000	12,000	7,000	25,000	12,000	7,000
電源線長度 (米)	2.0					
外形尺寸 (毫米)	594(闊)× 480(高)× 230(深)			940(闊)× 480(高)× 230(深)		
重量 (公斤)	10.5			15.0		

- *1 當主機貼近牆壁放置並在風速設定為“高速 (HIGH)”模式下運行時，在房間中心點附近位置（距離地面高度大約 1.2 米）能夠測得本機釋放出的離子簇濃度在目標房屋面積中為每立方厘米 25,000 顆。
- *2 當主機靠近牆壁放置時，在每個風速設定下，房間中央位置附近（距離地板大約 1.2 米高度）每立方厘米空氣中的離子簇數量。
- 離子簇的數量會因房間狀況及主機運行模式的不同而異。



待機功率

在電源插頭插入牆壁電源插座的情況下，為維持電路運作，本產品消耗的待機功率為大約 0.8 瓦。

為節約能源，在主機停用時請拔除電源線。

故障時的解決方法

在要求修理之前，請檢查下列症狀，因為有些問題可能不是本機故障而引致的。

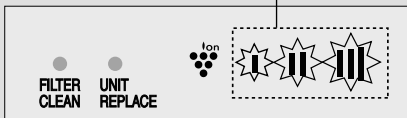
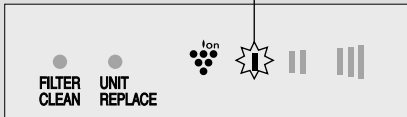
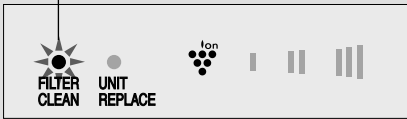
症狀	處理方法
<p>主機停止操作。</p>	<p>請確認電源插頭已經插好。</p>
<p>更快速地閃爍（紅色）</p> 	<p>已經使用了大約2年2個月(約19,000小時)。請更換一個新的HD離子產生器。參見C-8,9,10。</p>
<p>閃爍（紅色） 閃爍（藍色）</p> 	<p>未能釋放出離子簇。 按下“操作按鈕”，重新啓動本機。</p> <p>如果全部指示燈持續閃爍，則應更換新的HD離子產生器。參見C-8,9,10。</p> <ul style="list-style-type: none"> 灰塵可能阻塞了過濾網，請清潔過濾網。
<p>閃爍（藍色）</p>  <p>閃爍（藍色）</p> 	<p>系統故障 拔出插頭並聯絡購買的經銷商或聲寶服務中心。</p>
<p>釋出的空氣有異味。</p>	<p>本機會釋放出微量臭氧，可能會產生異味。但此異味對健康並無影響。</p>
<p>運行時，本機發出“喀噠”或“滴答”聲。</p>	<p>聲音的強度會根據房間濕度不同而發生變化，但其效能是相同的。必要時可重選位置擺放本機。</p>
<p>亮燈（黃色）</p> 	<p>到了過濾網清洗時間。請參見C-7頁。過濾網清洗完畢後，觸按過濾網重設按鈕並保持3秒鐘。</p>
<p>聽到不連續的噪音。 氣流減弱。</p>	<p>過濾網逐漸變髒。 清洗過濾網。 過濾網清洗完畢後，觸按過濾網重設按鈕並保持3秒鐘。</p>

SHARP®

SHARP CORPORATION

Osaka, Japan

Printed in Japan

TINS-A324KKRZ 09EK ①